

Pressure Reducing Valve - P160

ADCA Pure

ADCA PURE

Description

The ADCA P-160 series direct acting, spring-loaded diaphragm sensing , pressure reducing valves are designed for use on clean steam, compressed air, water and other gases or liquids compatible with the materials of construction.



Price
ON REQUEST

Materials

1	Valve body	AISI316L / 1.4404
2	Cover	AISI316L / 1.4404
3	Centering plate	AISI316L / 1.4404
4 *	Valve stem	AISI316L/1.4404
5 *	Soft plug	EPDM; PTFE **
6 *	Valve plug	AISI316L / 1.4404
7 *	Upper diaphragm	EPDM;VITON**
8 *	Lower diaphragm	PTFE
9	Diaphragm plate	AISI316L / 1.4404
10 *	O-ring	EPDM
11	Diaphragm plate	AISI316L / 1.4404
12	Stem guide	AISI316 / 1.4401
13	Spring plate	AISI316 / 1.4401
14	Nut	St.Steel A2 - 70
15	Washer	AISI316 / 1.4401
16 *	Adjustment spring	AISI 302 / 1.4300
17	Top spring plate	AISI316 / 1.4401
18	Retaining washer	St.Steel A2 - 70
19	Regulating nut	AISI316L / 1.4404
20	Adjustment screw	AISI304 / 1.4301
21	O-ring	EPDM
22	Bearing	Corrosion res. Steel
23	Ext. bowed shaft ring	Stainless steel
24	Cover nut	Plastic
25	Bolts	A2

* Available spare parts. ** Others according to the fluid
 FDA/USP Class VI seals certi ficate on request
 Viton diaphragm only with FDA approval (Pos.7)

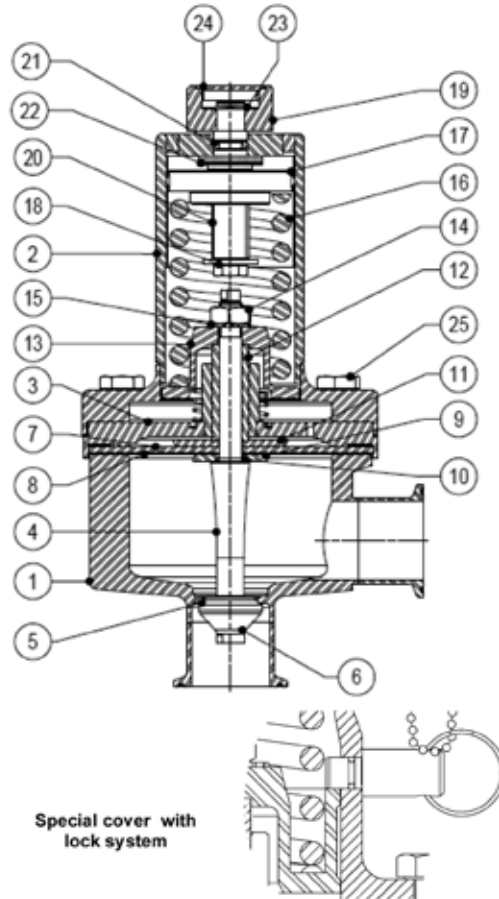

Capacities

Valve Size	3/4" - 20	1" - 25	1 1/2"-40	2"-50
KVs (m3/h)	1.3* - 3	3,5* - 4,5	5.3	**5.5 -8.5

*Max.available Kvs with ASME BPE clamp connection
 ** On request, for maximum inlet pressure higher than 4 bar

Limiting Conditions

Valve model	P-160
Body design conditions	PN 16
Max. upstream pressure	8 bar DN 2" only 4bar**
Max. downstream pressure	5 bar
Min.downstream pressure	0.8 bar
Max.design temperature *	150 °C

*Other on request.

**Special execution on request with lower Kvs