



Balanced Pressure Thermostatic Steam Trap - Clean Steam Trap TSS 6



Description

The TSS 6 all stainless steel thermostatic steam traps and air eliminators are specifically designed for use in reactors, sterilizers and distribution lines in clean and pure steam systems.

The small size makes it ideal for use with a wide variety of this equipment.

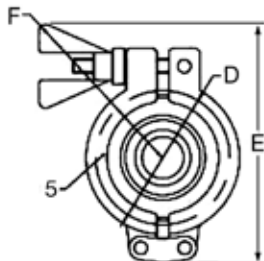

Materials

- 1 Body AISI 316L / 1.4404
- 2 Cover AISI 316L / 1.4404
- 3* Thermostat AISI 316L / 1.4404
- 4* Gasket PTFE/TFM @ Envelope Gasket**
- 5 Clamp Stainless Steel

* Available spare parts. ** USP Class VI approved

| |
|-------------------|
| Price |
| ON REQUEST |

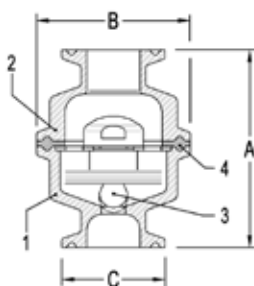

Flow Rate Capacity (Kgs/h)

| Model | Size | Differential Pressure (bar) | | | | | | | | |
|-------|------------|-----------------------------|-----|-----|-----|-----|-----|-----|------|------|
| | | 0,2 | 0,3 | 0,5 | 1 | 1,5 | 2 | 3 | 4 | 6 |
| TSS6 | 1/2"-11/2" | 90 | 135 | 200 | 400 | 500 | 700 | 900 | 1000 | 1400 |
| TSS6L | 1/2"-11/2" | 60 | 80 | 90 | 160 | 210 | 280 | 490 | 550 | 760 |

Capacities shown refer to condensate at 5°C below saturated steam temperature. Capacities for cold condensate discharge at 20°C are around two times greater.



Sanitary Pressure Reducing Valve - P130

Description

The ADCA P-130 series *direct acting, spring-loaded diaphragm sensing*, pressure reducing valves are designed for use on compressed air, water and other gases or liquids compatible with the materials of construction.

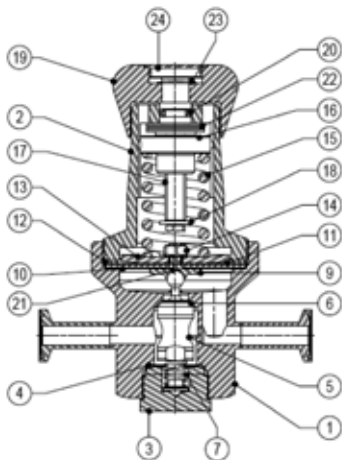

Materials

- 1 Valve body AISI316L / 1.4406
- 2 Cover AISI316L / 1.4404
- 3 Seat cover AISI316L / 1.4404
- 4* O-ring Viton / EPDM
- 5* Piston AISI316L / 1.4404
- 6* Valve head AISI316L / 1.4404; Viton, PTFE
- 7* Valve spring AISI302 / 1.4300 (Polished)
- 9 Pusher disc AISI 316L / 1.4404
- 10* Lower diaphragm PTFE
- 11* Upper diaphragm EPDM
- 12 Washer AISI304 / 1.4301
- 13 Spring plate AISI304 / 1.4301
- 14 Nut St.steel A2-70
- 15* Adjustment spring AISI302 / 1.4300
- 16 Spring plate AISI304 / 1.4301
- 17 Adjustment screw AISI304 / 1.4301
- 18 Retaining washer St.steel A2-70
- 19 Handwheel AISI316L / 1.4404
- 19 Handwheel Aluminium white painted
- 20 O-ring EPDM
- 21** O-ring EPDM
- 22 Bearing Corrosion res. Steel
- 23 Ext.bowed shaft ring Stainless steel
- 24 Cover nut Plastic
- 25 Captured vent ring AISI 316L / 1.4404

* Available spare parts. ** On Request

Remarks: FDA/USP Class VI seals certificate on request All valves have a serial number. In case of non-standard valves this number must be supplied if spare parts are ordered.

| |
|-------------------|
| Price |
| ON REQUEST |

Limiting Conditions

| | |
|---------------------------|---------|
| Valve model | P-130 |
| Body design conditions | PN 16 |
| Max. upstream pressure | 16 bar |
| Max. downstream pressure | 8 bar |
| Min. downstream pressure | 0,2 bar |
| Max. design temperature * | 150 °C |

*Other on request.

Capacities

| Valve Size | 1/2" - 15 | 3/4" - 20 | 1" - 25 |
|------------|-----------|-----------|---------|
| KVs (m3/h) | 3 | 3.2 | 3.3 |

Reduced Kv on request